

Pos. Nr. Pos.no.	Beschreibung Description	Art.-Nr. Art.no.	Preisgruppe Price bracket
70273 CSD Br 555.1 =			
70274 = 🔊			
1	Kessel komplett Betr. nr. 555.109 Boiler assembly Loco.no. 555.109	146438	36
2	Kesselboden Boiler bottom	132706	12
3	Kesselsteckteilesatz Boiler plug-in parts	100145	9
4	Lokgewicht Boiler weight	109802	8
5	Schaltstange 0,4 x 37 mm Control rod 0,4 x 37	100169	4
6	Schaltstange 0,4 x 49,7 Control rod 0,4 x 49,7	100170	4
7	Schaltstange 0,4 x 93 mm Control rod 0,4 x 93	100171	4
8	Schaltstange 0,4 x 100 mm Control rod 0,4 x 100	100172	4
9	TS - Sandrohr, Kesselrohr Part set - sand pipe, boiler pipe	100146	9
10	Windleitblech links und rechts Wind deflector left & right	100489	8
11	Kupplungsauflage Coupling rod cover	100277	4
12	TS - Fenster und Lichtleiter Part set of window and light conductor	100677	9
13	TS - Kesselsteckteile Part set of boiler plug-in parts	100678	13
14	Wasserpumpe 1 Water pump 1	106371	5
15	GF-Schraube M2x5 mm Self-tapping screw M2x5	114966	3
16	Sandrohrsatz und Griffstangen Sand pipe and hand-rail set	120206	9
17	Teilesatz Kessel - Tender Part set boiler - tender	120207	8
18	Tafelsatz Set of panels	146442	12
19	Lichtabdeckung Light cover	122502	3
20	Führerhaus Drivers cab	146440	19
21	Stirnlichtleiter Front light conductor	131122	5
22	Ölkanne Oil can	92453	4
23	Lichtnagel Light pin	123902	3
24	Umlaufblech Running board	146441	16
25	Stern CSD Star	146439	4
26	Stirnlampe Headlamp	123903	6
Sound			
27	GF-Schraube M1,6x4 mm Self-tapping screw M1,6x4	114850	3
28	Lautsprecher Loudspeaker	129524	13
29	Lautsprecherplatine PCB for loudspeaker	133613	11
30	Kontaktstift m. Litze Contact pin with lead	132794	4

Änderungen in Konstruktion und Ausführung vorbehalten
We reserve the right to change the construction and specification

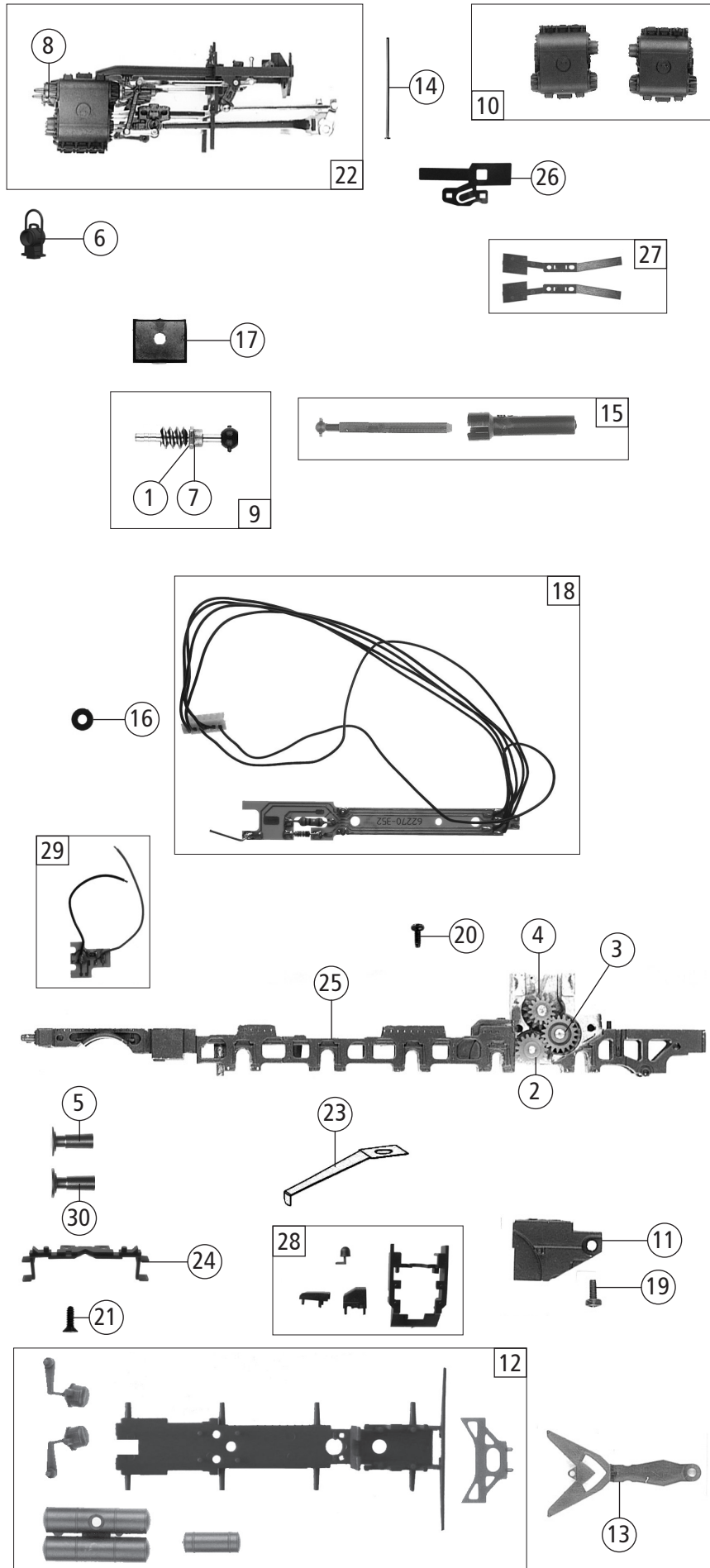

Pos. Nr. Pos.no.	Beschreibung Description	Art.-Nr. Art.no.	Preisgruppe Price bracket
1	Beilagscheibe Washer	86108	3
2	Zahnrad Z=17 Gear wheel Z=17	86409	5
3	Zahnrad Z=19 M=0,4 Gear wheel Z=19 M=0,4	86417	3
4	Schnecken Zahnrad Z=15/14 Worm gear wheel Z=15/14	86490	5
5	Puffer rund flach Buffer round flat	88556	5
6	Loklampe groß lack. Loco lamp big painted	139253	4
7	Lager für Schneckenachse Bearing for worm gear axle	89749	6
8	TS - Schiebereinsatz Part set slide inset	92420	3
9	Schneckensatz mit Kardankugel Set of worm gear incl. cardan ball	100132	13
10	Zylinderblocksatz Cylinder block set	100168	12
11	Lokgetriebedeckel Loco gear cover	100290	12
12	TS - Platinenabdeckung Part set PCB cover	100295	10
13	Lok Tender-kupplung Loco tender coupling	100296	8
14	Drahtstift Tack	110641	4
15	Kardanwelle und Kardanhülse Cardan shaft and cardan reception	111765	4
16	Platinenring Rim for PCB	125002	9
17	Schneckenkammerdeckel Worm gearbox cover	111987	4
18	Lokplatine komplett Loco PCB assembly	125019	20
19	GF-Schraube M2x5 mm Self-tapping screw M2x5	114966	3
20	GF-Schraube M1,6x4 mm Self-tapping screw M1,6x4	114850	3
21	SK-Schraube M1,6x4 mm SK-Screw M1,6x4	115161	3
22	Steuerung kpl. Reversing gear complete	146437	34
23	Vorlaufgestellfeder Bogie spring	125024	3
24	Loktreppe Loco treadle	125083	4
25	Lokgrundrahmen Loco basic frame	146430	16
26	Radkontakt Wheel contact	131126	5
27	Radkontakt links und rechts Wheel contact left and right	124976	6
28	TS - Dachaufsatz, Werkzeugkasten Part set	124996	7
29	Stirn-LED-Platine kpl. Front -LED-PCB complete	125020	12
30	Puffer rund gewölbt Buffer round curved	88557	5

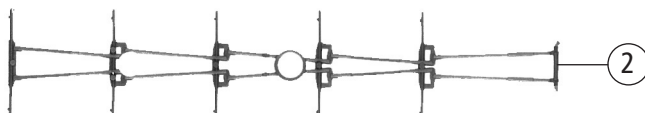
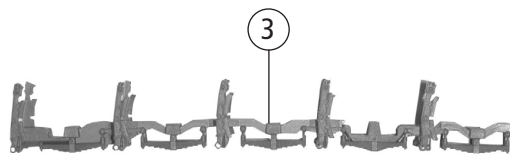
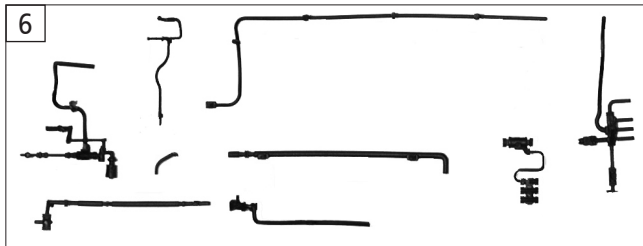
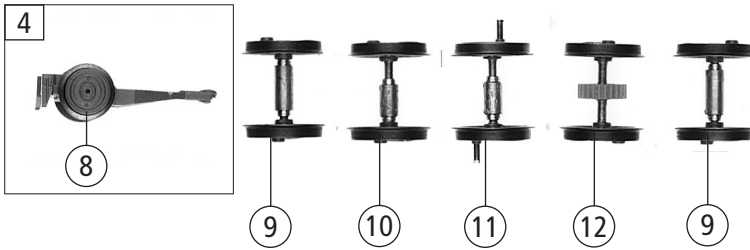

70273		CSD	Br 555.1	=	
70274				=	🔊
Pos. Nr. Pos.no.	Beschreibung Description	Art.-Nr. Art.no.	Preisgruppe Price bracket		
1	TS - Stoppel vorne/hinten Part set plugs front/back	138069	5		
2	Bremsgestänge Brake rigging	100292	3		
3	Bremsrahmen Brakes frame	100308	12		
4	Vorlaufgestell Carrying wheels	135479	8		
5	TS - Kuppelstangen Part set - Coupling rod	142173	18		
6	TS - Kesselleitungen und Ventile Part set boiler lines and valves	108329	10		
7	GF-Schraube M2x25 mm Self-tapping screw M2x25	115533	3		
8	Vorlaufradsatz Pony truck wheelset	142167	9		
9	Radsatz 1+5 m. Achslager lang Wheelset 1+5 with axle bearing long	142168	12		
10	Kuppelradsatz 2 m. Achslager klein Coupled wheelset 2 w. axle bearing short	142169	12		
11	Treibradsatz 3 m. Achslager klein Driving wheelset 3 with axle bearing short	142170	12		
12	Kuppelradsatz 4 mit Zahrad Coupled wheelset 4 w. gear wheel	142171	12		
13	GF-Schraube M 2x4 mm Self-tapping screw M 2x4	114877	3		

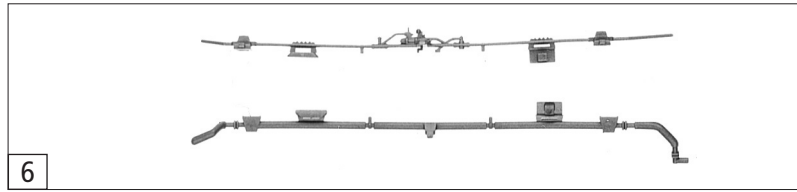

6

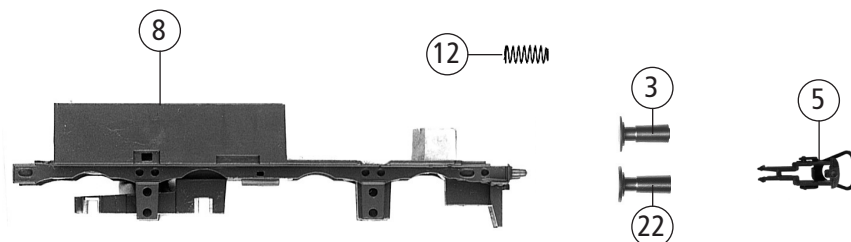
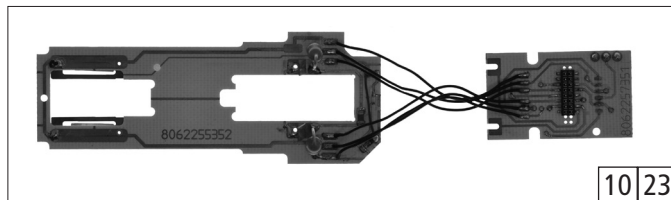
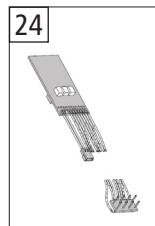
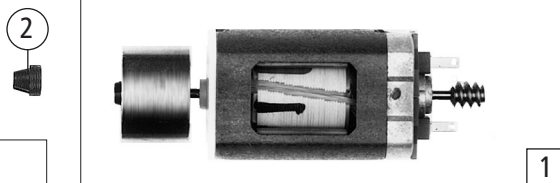
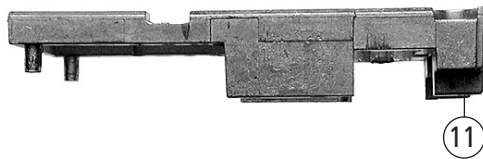
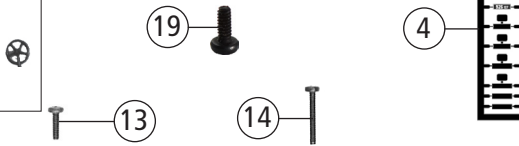
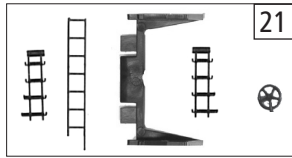
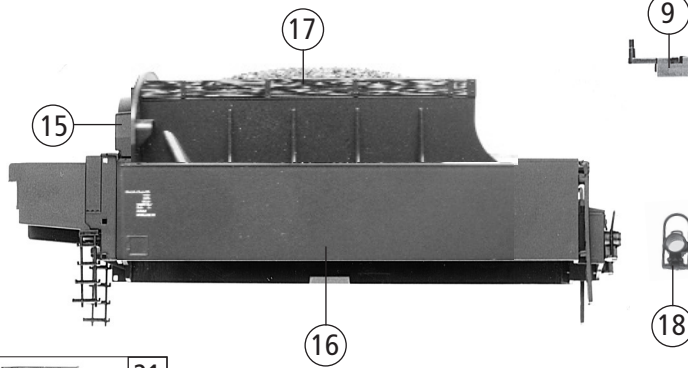

Pos. Nr. Pos.no.	Beschreibung Description	Art.-Nr. Art.no.	Preisgruppe Price bracket
1	Motor Motor	85131	28
2	Kardanschale kurz Cardan reception,short	87129	4
3	Puffer rund flach Buffer round flat	88556	5
4	Nummertafeln Number boards	146432	10
5	Standardkupplung Standard coupling	89246	6
6	TS - Tenderleitungen Part set of tender pipes	100299	7
7	Brückenstecker Connector	129630	10
8	Tendergrundrahmen Tender basic frame	146431	16
9	Kupplungskammer Coupling reception	108225	4
10	Tenderplatine mit LED Tender PCB with LED	131130	24
11	Tendergewicht Tender weight	109405	8
12	Bürstenfeder Brush spring	114197	3
13	GF-Schraube M1,6X6 mm Self-tapping screw M1,6X6	114836	3
14	GF-Schraube M1,6x10 mm Self-tapping screw M1,6x10	114881	3
15	Kohlekasten und Stirnteil Coal box and frontside part	116381	12
16	Tendergehäuse Betr. nr. 926.127 Tender body Loco no. 926.127	146433	14
17	Kohlegewicht Coal weight	109868	10
18	Tenderlampe groß bedr. Tender lamp big printed	139259	5
19	GF - Schraube M1,6x4 mm GF - Screw	114850	3
20	Zugfeder Draw spring	86208	3
21	TS - Tender 1 Part set of tender 1	108330	12
22	Puffer rund gewölbt Buffer round curved	88557	5
Sound			
23	Tenderplatine m. LED Tender PCB with LED	132128	28
24	Sounddecoder Sound-decoder	130205	39

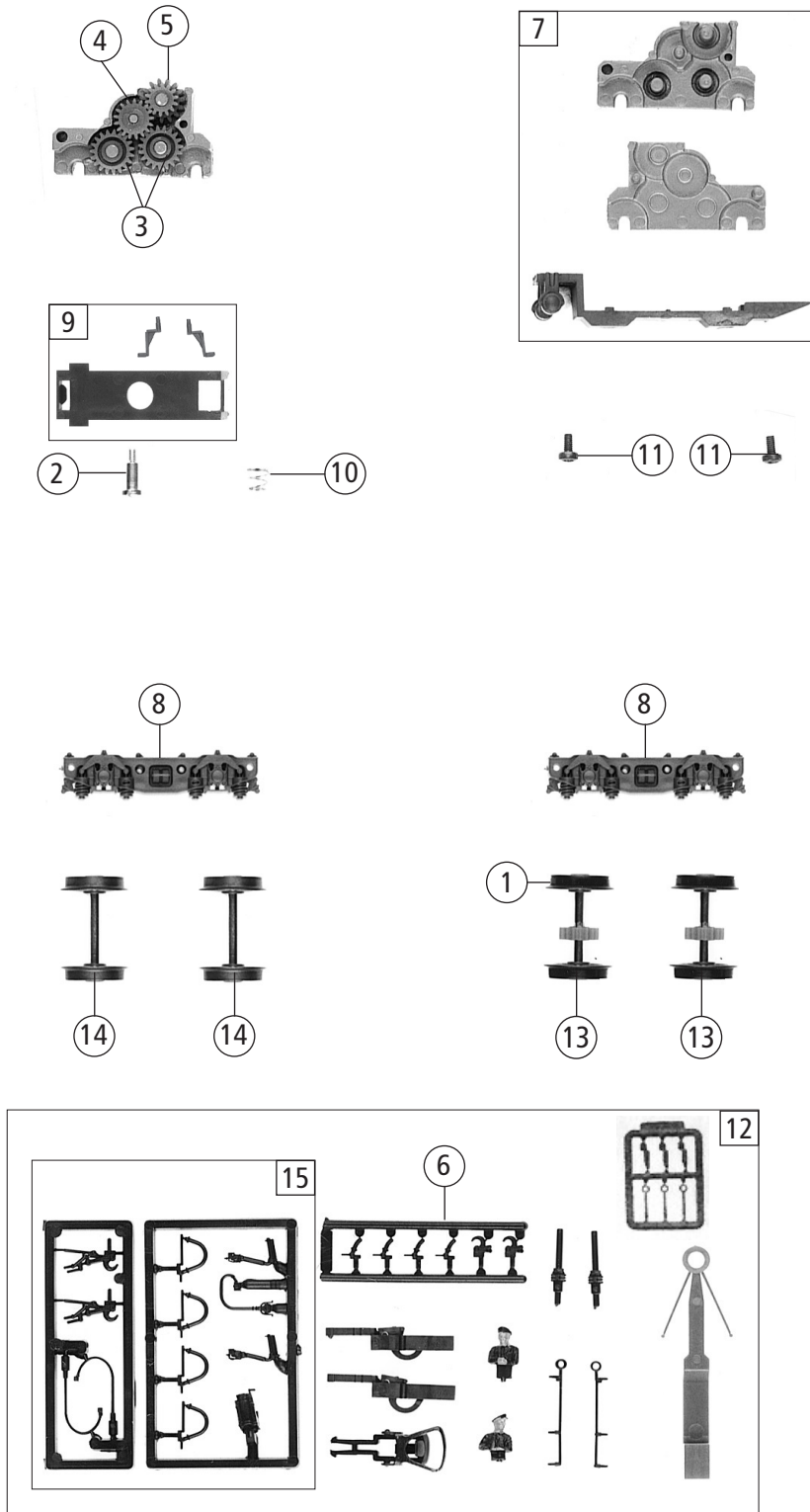

Pos. Nr. Pos.no.	Beschreibung Description	Art.-Nr. Art.no.	Preisgruppe Price bracket
1	Hafrings.10Stk.10,3-12,8mm Traction tyres set	40069	---
2	Ansatzschraube M2x5 mm Flanged screw M2x5	85669	4
3	Zahnrad Z=19 M=0,4 Gear wheel Z=19 M=0,4	86417	3
4	Zahnrad Z=17 M=0,4 G Gear wheel Z=17 M=0,4 G	86418	5
5	Schnecken Zahnrad Z=15/14 Worm gear wheel Z=15/14	86490	5
6	Attrappenrahmen klein Small dummy frame	107808	4
7	Tendergetriebebesatz 3-tlg. Tender gear set 3-parts	100302	13
8	Blende für Tender Bogie for Tender	100306	9
9	Tenderachsdeckel + tendertritte Tender axle cover + tender steps	100307	8
10	Laufgestelldruckfeder Bogie pressure spring	108226	3
11	GF -Schraube M2x4 mm Self-tapping screw M2x4	114877	3
12	Zurüstbeutel Bag with accessories	121268	13
13	Radsatz mit 2 Hafringen mit Zahnrad Radsatz with 2 traction tyres with gear wheel	100300	11
14	Radsatz ohne Zahnrad ohne Hafringen Wheelset w/o gear wheel w/o traction tyres	114352	9
15	Zubehör Rahmensatz Set of accessory frames	108322	7